

## Southbound on the Northbound – A Brewster River Quest

*Begin this quest at the silos on VT Route 15 in Jeffersonville.*

As you stand and look around,  
You will see an old bearded man looking down,  
Also a boy, take your time, don't rush,  
They both are accompanied by a hermit thrush.

Now leave these silos for a test,  
And see if you can complete this quest.

From the silos, turn right on Main Street,  
Now a left on Old Main, stay on your feet!  
Look around and you may see a horse,  
The walking path is straight ahead of course.

Follow the path until you see a wooden post.  
Stop and turn right on a footpath that will boast  
The way to get to the river's edge,  
Now stop and stand on this ledge.

Look toward the bridge on Route 15  
Here a lot of flooding has been seen.

Continue upstream until you reach,  
The part of the river with a pebble beach  
Stay up on the bank if the river is high.

That way you will stay nice and dry.

If the river is not too high for you,  
Head down to the pebble beach for another view.

Across the river, tree roots are exposed,  
As water rushing past the banks erodes.

Follow the beach until the path starts again  
Up onto the riverbank it will ascend.  
Now follow the river into a field.  
Stand where you see willows growing as a shield.

These willows are a riparian buffer,  
They keep soil and chemicals out of the river so it doesn't suffer.

Now continue along the river,  
\*To a path through the woods that will make you shiver.  
Keep going until you see some buses,  
Here stop and look at the river as it rushes.

\*As the tiny walking path through the woods was recently closed to the public, you will need to cross through the water or around on the street to get to the bus parking area.

Here the river runs straight and fast,  
Which caused the erosion you already passed.

Follow the river upstream again until a baseball field you reach,  
Behind the bleachers let us teach,  
More about the Brewster River and its run,  
We hope that this quest has been a lot of fun.

This river starts way up on the mountaintop,  
And at Jeffersonville it does not stop.  
It joins the Lamoille and heads west,  
Into Lake Champlain where it stops for a rest.

As for our Quest, you've reached the end,  
Thanks for taking a walk around the river bend.  
Now look around for a box in a tree,  
Please sign your name for everyone to see.

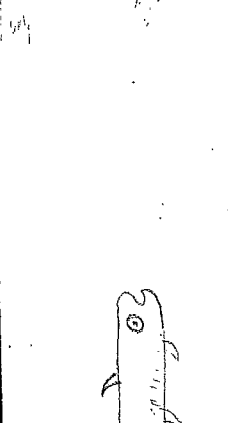
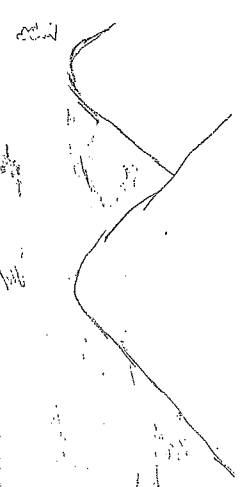
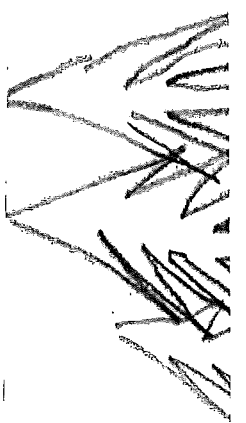
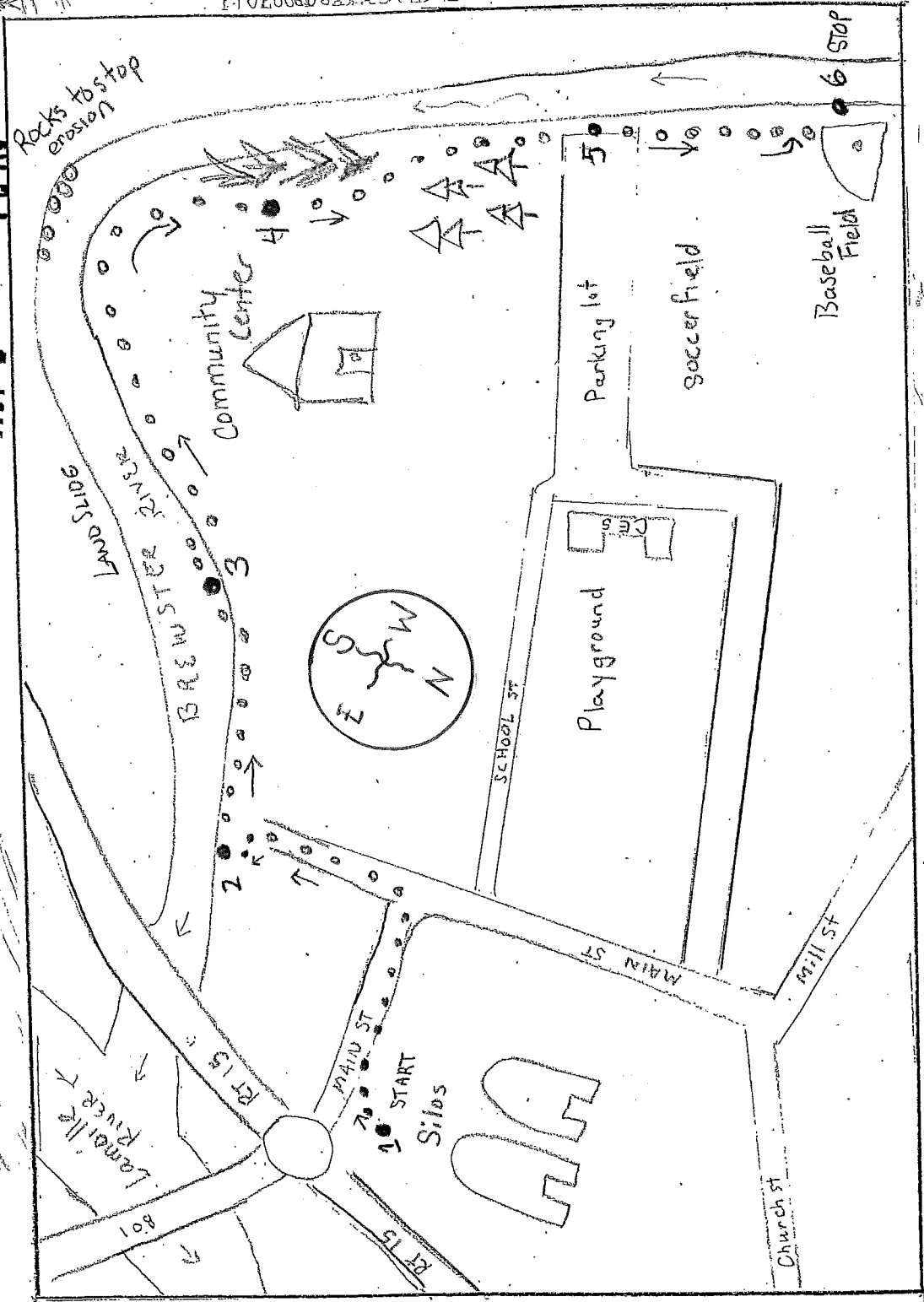

Hand-drawn signature or scribble at the bottom right of the page.